

# DV59 LED



**A** purpose built robust underwater LED dock light designed to withstand the saltwater or freshwater environment. This marine dock light manufactured in aluminum bronze incorporates the latest LED high density chip technology with a borosilicate marine grade glass lens and GFCI protection. The underwater dock light can be mounted horizontally on any structure or simply placed on the sea, lake or pond bottom. Available in white, blue, green, red or color changing RGB.

The driver box can be ordered with an attached photo cell for automatic switching at dusk. There is also an optional mounting bracket available that can be used to attach the dock light to fixed structures.



## *DV59LED technical specifications*

Application for:	Floating docks, pilings, marinas, waterside restaurants and houses	Driver Box Dimensions:	11.5" (292mm) long x 9.3" (235mm) wide x 5.2" (132mm) deep
Glass Lens:	Clear borosilicate	Light Construction:	Marine bronze Stainless Steel fasteners
Thickness:	0.19" / 48mm	Driver Box Construction:	Gray molded fiberglass polyester
Diameter:	4.2" / 106mm	Installation:	Fastened to a flat surface by way of a mounting bracket or lay flat on bottom
Driver:	100 – 277VAC 50/60Hz 2.0 – 0.68 Amps input range 150W output	<i>NOTE: All information is subject to change without prior notice, please confirm details prior to ordering.</i>	
Light Source:	High density LED array White, blue, green, red or color changing		
Lumens:	15,000		
Life Length:	Approx. 30,000 hours		
Light Dimensions:	5.9" (150mm) diameter x 1.4" (35mm) deep		



1881 W State Road 84, Bay 102, Fort Lauderdale, FL 33315 USA  
T. 954 760 4447 Toll Free 1 866 772 0130 F. 954 525 3261  
sales@seavision.com www.seavision.com

# DV59 LED Light

120-230VAC



## **Introduction:**

Congratulations on the purchase of your new LED dock light with matching driver box. Underwater Lights® USA, LLC takes pride in providing well designed, high quality and thoroughly tested lights that allow you to “enhance your boating experience”. This LED light can be installed on your dock for aesthetics, to attract fish and/or for security and safety.

## **General Information (LED Light):**

The latest commercial grade “COB” High-Density Light Emitting Diode (LED) technology used in this light will provide robust and reliable operation under normal operating conditions when used with the matching driver box.

Internal thermal limit protection included. Note: Optimum performance and longevity will be achieved when operating underwater.

This light is intended for underwater lighting applications.

Depending upon water clarity conditions, the light beam can reach up to 30 meters (100 feet).

## **General Information (Driver Box):**

Includes the latest control technology and electronic component construction to guarantee high levels of performance.

Universal VAC input with short circuit, over current, over voltage and over temperature protections.

Electrical cable attached GFCI male plug and electrical wiring terminal block with VAC input fuse protection.

## **Safety Information:**

Always disconnect and lock-out power before working on the LED light.

Always ensure that VAC power is disconnected and locked out before performing driver box installation and/or service.

Never operate without GFCI protection at power source.

## **Care and Maintenance:**

Marine growth should be regularly removed from the LED light lens using a soft brush to allow clear illumination from the light.

Clear antifouling coating can be applied to aid with reducing marine growth (ie: SeaClear®).

The matching driver box should be opened and visually inspected every six months.

LED light and matching driver box electrical cabling should be visually inspected for proper operating condition every six months.

## **Technical Specifications:**

Light source = Instant-on high flux, high density LED array - 14,630 maximum Lumens and 7000 Kelvin color temperature in White  
- Available in Blue, Green, Red or RGB changing LED array's - Approx 15,000 hours life

Lense = Clear borosilicate glass - 4.8mm (0.19”) thick - 106mm (4.2”) diameter net aperture

Light dimensions = 150mm (5.9”) diameter x 35mm (1.4”) long - 2936 grams (6.5 lbs)

Light construction = Marine bronze - Stainless steel fasteners

Driver box dimensions = 292mm (11.5”) long x 235mm (9.3”) wide x 132mm (5.2”) deep - 2127 grams (4.7 pounds)

Driver box construction = Gray molded fiberglass polyester with polyurethane gasket, IP66/NEMA 4X rated

Driver = 100-277VAC, 50/60 Hz, 2.0-0.68 Ampere input range - 150 Watt output

Cable to driver box = Marine grade electrical cable, 16/3 stranded copper wire

Cable from driver box to LED light = Marine grade electrical cable, 16/2 stranded copper wire

Terminal block fuse = Fast blow 10 Amp cylindrical, 6.3mm diameter x 25mm or 32mm long (0.25” diameter x 1.0” or 1.25” long)

## **Troubleshooting:**

Please contact our technical support staff in Florida at 1-954-760-4447, Monday to Friday from 8:00 am to 5:00 pm EST.

## **Warranty:**

Underwater Lights® USA, LLC warrants this LED light and matching driver box to be free from defects in workmanship and materials for a period of two years from the date of original purchase. Further, misuse, abuse, improper installation, neglect, improper shipping, damage caused by disasters such as fire, flood and lightning, unauthorized repair or modifications will void said warranty. Should your LED light and/or matching driver box prove defective during the warranty period, promptly contact Underwater Lights® USA, LLC for an RMA number and then return the LED light and/or matching driver box freight prepaid with the RMA number clearly marked on the outside of the shipping container.

Underwater Lights USA, LLC  
1881 W State Road 84, Bay 102  
Fort Lauderdale, FL 33315 USA  
Phone: 1-954-760-4447  
Fax: 1-954-525-3261  
Internet: [www.seavision.com](http://www.seavision.com)  
Email: [sales@seavision.com](mailto:sales@seavision.com)

DOC:021113-4

Underwater Lights Europe Sarl  
16, rue Rouaze  
06400 Cannes, France  
Phone: 33-(0)-4-97-21-02-96  
Fax: 33-(0)-4-97-21-10-96  
Internet: [www.seavision.com](http://www.seavision.com)  
Email: [sales@seavisioneurope.com](mailto:sales@seavisioneurope.com)

# DV59 LED Light

120-230VAC



## Installation:

Ensure that the LED light will be submerged at low tide (if applicable), then select a flat mounting surface for the light and secure by way of two Main Body (1) M8 x 1.25 x 9mm deep threaded holes or simply lay on bottom facing up. Note: An optional mounting bar is also available. Caution! Route LED light electrical cable away from any sharp edges/surfaces.

Preferably, the matching driver box should be mounted in a cool, dry, well ventilated and easily accessible location. Attach the driver box to a fixed bulkhead or similar secure structure using four appropriate M8 fasteners, leaving adequate space between adjacent driver boxes for proper cooling. Note: Whereas the driver box can be placed in any orientation, it is recommended that the cable strain relief connectors face down. Insert the provided GFCI male plug into a standard 120V/15A wall outlet.

## Serviceable Parts (LED Light):

The LED light is factory rebuildable only. For all servicing call and request an RMA number and return the LED light to the US office for repair and/or rebuilding.

## Serviceable Parts (Driver Box):

Upon opening the driver box by unscrewing four captive lid fasteners, replacement of Driver (12) or Fused Terminal Block (14) is accomplished by removal and replacement of associated fasteners and wiring (see diagram below). Further, a 10 Amp Fast Blow Fuse (16) located in the Fused Terminal Block (14) may be pulled out and replaced as required. **Caution! Ensure that VAC power is disconnected and locked out before servicing driver box.**

MODEL 13C15B39B67B99 LED LIGHT WITH DRIVER BOX		
BALLOON	PART	DESCRIPTION
1	59001	MAIN BODY, BRONZE*
2	59006	FRONT FLANGE, BRONZE*
3	59012	LENSE
4	59013	WIRE PULL HANDLE
5	59020	LED ARRAY*
6	59011	GLASS GASKET
7	59026	M8 x 1.25 x 20 LG SST HEX BOLT
8	59028	CABLE STRAIN RELIEF
9	59029	ELECTRICAL CABLE
10	59030	ENCLOSURE
11	59031	MOUNTING PLATE
12	59032	DRIVER
13	59036	M4 x 0.7 x 6LG SST PHILLIPS PAN HEAD SCREW
14	59033	FUSED TERMINAL BLOCK
15	59037	M3.5 x 0.6 x 12LG PPHS
16	59034	FAST BLOW FUSE
17	59035	CABLE STRAIN RELIEF
18	59043	GFCI MALE PLUG*
19	59039	ELECTRICAL CABLE

\*PLEASE CALL FOR OTHER PRODUCT COMPONENT CONFIGURATIONS

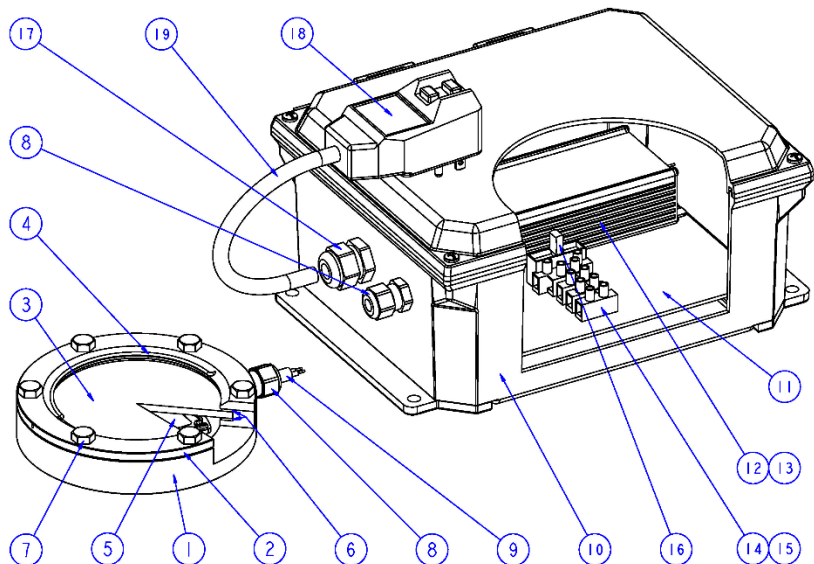
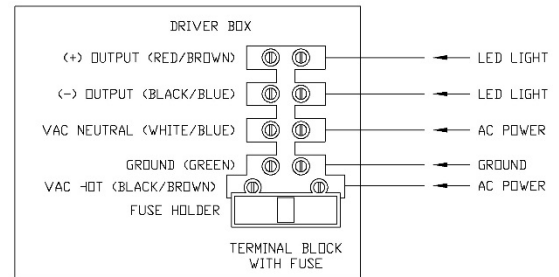

Underwater Lights USA, LLC  
 1881 W State Road 84, Bay 102  
 Fort Lauderdale, FL 33315 USA  
 Phone: 1-954-760-4447  
 Fax: 1-954-525-3261  
 Internet: [www.seavision.com](http://www.seavision.com)  
 Email: [sales@seavision.com](mailto:sales@seavision.com)

DOC:021113-4

Underwater Lights Europe Sarl  
 16, rue Rouaze  
 06400 Cannes, France  
 Phone: 33-(0)-4-97-21-02-96  
 Fax: 33-(0)-4-97-21-10-96  
 Internet: [www.seavision.com](http://www.seavision.com)  
 Email: [sales@seavisioneurope.com](mailto:sales@seavisioneurope.com)